

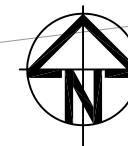

Scheme Ref.	NoF Signage - HSN / 001		
Sign Ref.	Schedule 4, Part 1, Dia 2	x-height	20.0
Letter colour	BLACK	SIGN FACE	
Background	WHITE	Width	305mm
Border	BLACK	Height	225mm
Material	Class R2	Area	0.07m ²



- KEY:
- PROPOSED SIGN & POST
 - PROPOSED ELECTRIC VEHICLE CHARGING POINT
 - PROPOSED 100mm UPVC DUCT FOR ELECTRICAL CABLE
 - PROPOSED FEEDER PILLAR

- NOTES:
1. ALL DIMENSIONS ARE IN METRES UNLESS STATED OTHERWISE.
 2. THIS DRAWING IS TO BE READ IN CONJUNCTION WITH THE FOLLOWING DRAWINGS No's: NoF/ARC/HGN/ZZ/DR/101-103.
 3. PROPOSED PARKING LAYOUT BASED ON LBH CAR PARK LAYOUT DRAWING.
 4. DESIGN BASED ON OS PLANS.
 5. SIGNS & POSTS TO BE INSTALLED TO LBH SPECIFICATION. WITH A MINIMUM CLEARANCE OF 450mm FROM THE CARRIAGEWAY.
 6. FEEDER PILLAR, ELECTRIC CHARGING MACHINE AND ELECTRICAL SUPPLY TO BE SPECIFIED BY SUPPLIER.
 7. ALL SIGNS AND ROAD MARKINGS ARE TO BE IN ACCORDANCE WITH TSRGD 2016.
 8. THE LOCATION OF STATUTORY UNDERTAKERS APPARATUS SHOULD BE PROVED BY THE CONTRACTOR BEFORE UNDERTAKING ANY EXCAVATION.

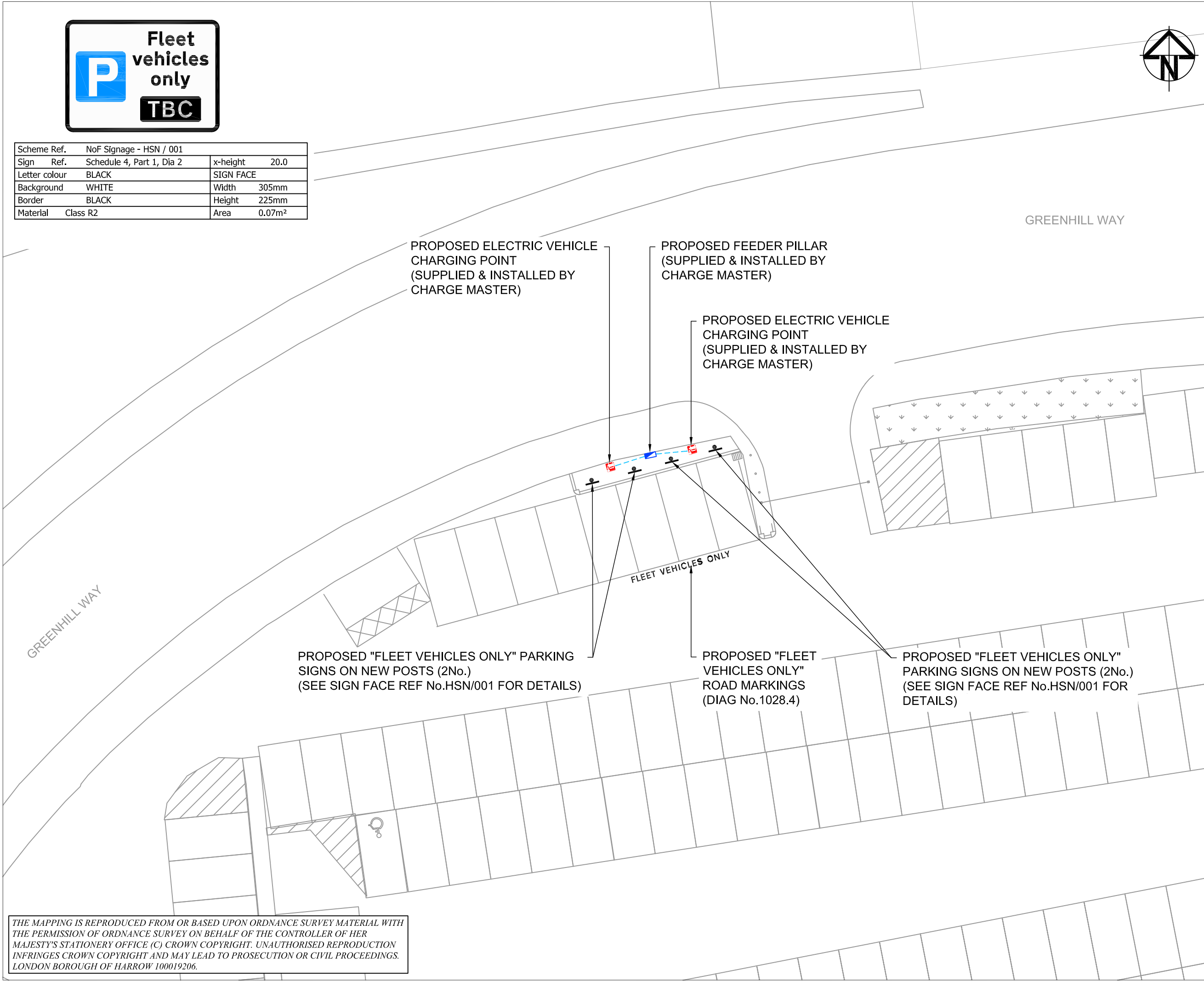

01	14.09.18	ORIGINAL ISSUE	MBW	DWH	JJM
Rev	Date	Description	Drawn	Check	Approv

Client

PROJECT:
NEIGHBOURHOOD
OF THE FUTURE

Site: LONDON BOROUGH OF HARROW
Client: HARROW COUNCIL
STATION ROAD
HARROW
HA1 2XY
www.harrow.gov.uk

ARCADIS Design & Consultancy for roads and built assets

Registered office: Arcadis House, 34 York Way, London, N1 9AB
Coordinating office: Bernard Weatherill House, 8 Mint Walk, Croydon, CR0 1EA
Tel: 44 (0)203 014 9000
www.arcadis.com

TITLE:
**GREENHILL WAY
CAR PARK
ELECTRIC FLEET VEHICLE
PARKING BAYS**

Designed	M. WHEELER	Date	SEPT 2018
Drawn	M. WHEELER	Date	SEPT 2018
Checked	D. HARDWICK	Date	14 SEPT 2018
Approved	J. MALYON	Date	14 SEPT 2018
Scale:	1:200	Datum:	AOD
Original Size:	A3	Grid:	OS
Suitability Code:	Sx	Project Number:	10019769

Suitability Description:
DETAIL DESIGN

Drawing Number:	NoF/ARC/HGN/ZZ/DR/101	Revision:	01
-----------------	-----------------------	-----------	----

THE MAPPING IS REPRODUCED FROM OR BASED UPON ORDNANCE SURVEY MATERIAL WITH THE PERMISSION OF ORDNANCE SURVEY ON BEHALF OF THE CONTROLLER OF HER MAJESTY'S STATIONERY OFFICE (C) CROWN COPYRIGHT. UNAUTHORISED REPRODUCTION INFRINGES CROWN COPYRIGHT AND MAY LEAD TO PROSECUTION OR CIVIL PROCEEDINGS. LONDON BOROUGH OF HARROW 100019206.

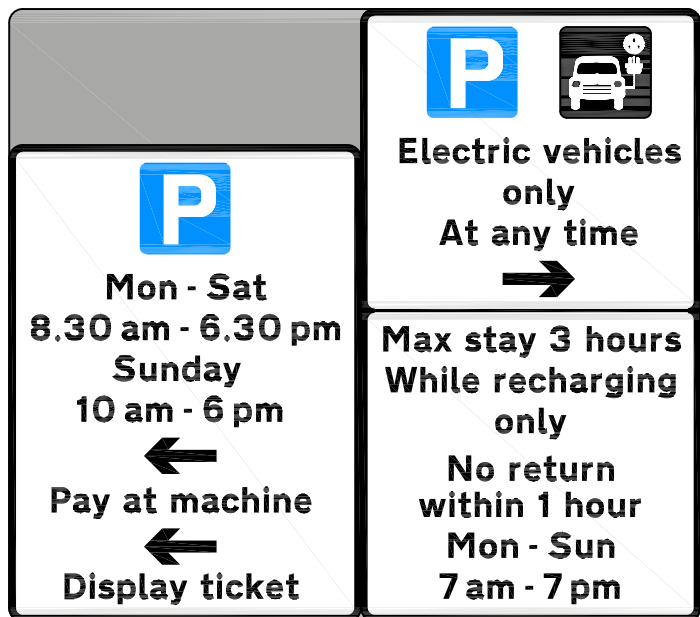

Scheme Ref.	NoF Parking Sign - HSN / 002A
Sign Ref.	Schedule 4, Part 1, Dia 2
Letter colour	BLACK
Background	WHITE
Border	BLACK
Material	Class R2

Scheme Ref.	NoF Signage - HSN / 002B
Sign Ref.	Schedule 4, Part 1, Dia 2
Letter colour	BLACK
Background	WHITE
Border	BLACK
Material	Class R2

Scheme Ref.	NoF Signage - HSN / 002
Sign Ref.	Schedule 4, Part 1, Dia 2
Letter colour	n/a
Background	GREY
Border	n/a
Material	Class R2

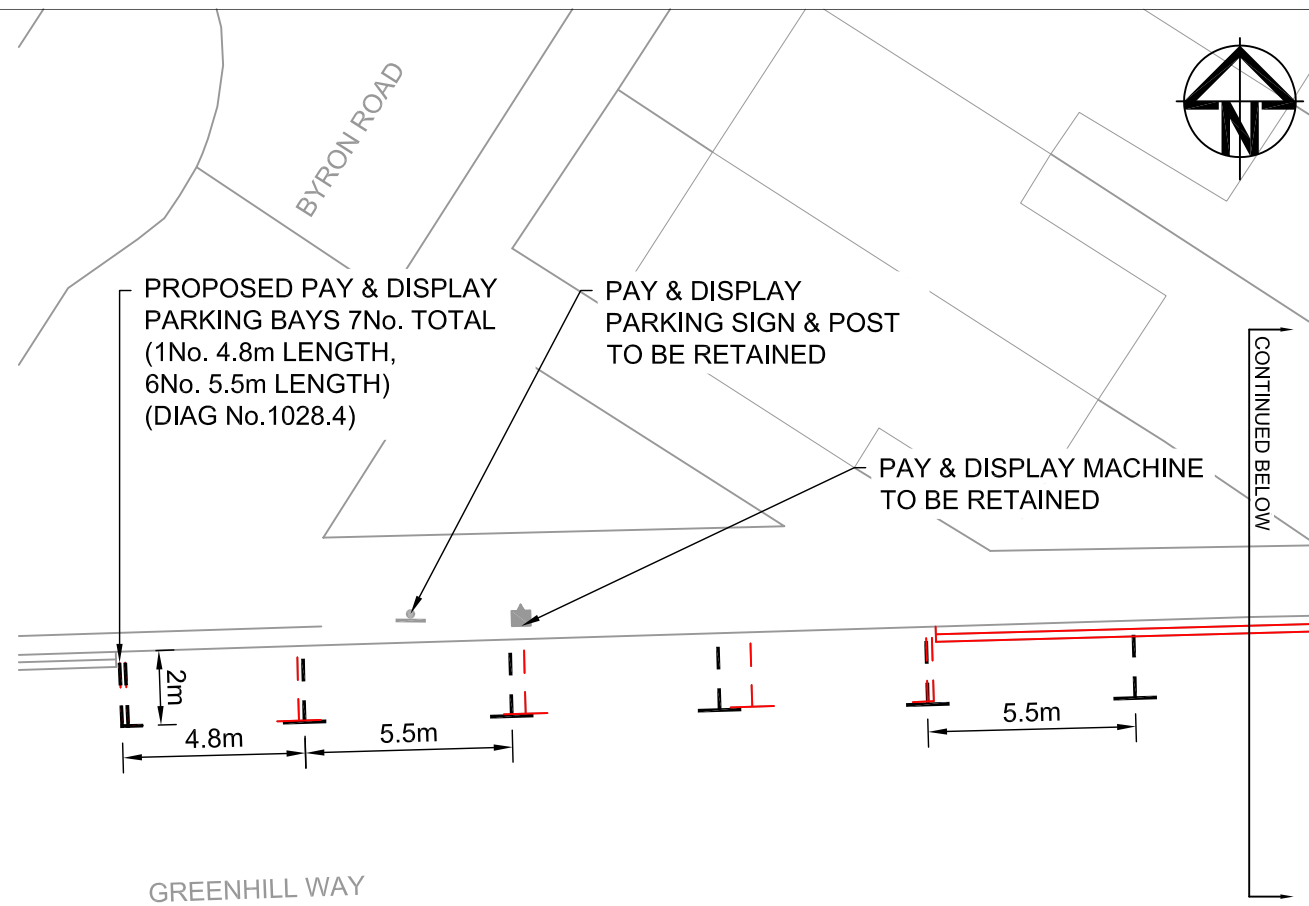

- KEY:
- PROPOSED SIGN & POST
 - PROPOSED ELECTRIC VEHICLE CHARGING POINT
 - PROPOSED 100mm UPVC DUCT FOR ELECTRICAL CABLE
 - PROPOSED FEEDER PILLAR
 - SETTING OUT MARKER
 - EXISTING ROAD MARKINGS TO BE REMOVED

- NOTES:
- ALL DIMENSIONS ARE IN METRES UNLESS STATED OTHERWISE.
 - THIS DRAWING IS TO BE READ IN CONJUNCTION WITH THE FOLLOWING DRAWINGS No's: NOF/ARC/HGN/ZZ/DR/101-103.
 - DESIGN BASED ON OS PLANS.
 - SIGNS & POSTS TO BE INSTALLED TO LBH SPECIFICATION. WITH A MINIMUM CLEARANCE OF 450mm FROM THE CARRIAGEWAY AND NOT TO OBSTRUCT DOORS OR WINDOWS.
 - FEEDER PILLAR, ELECTRIC CHARGING MACHINE AND ELECTRICAL SUPPLY TO BE SPECIFIED BY SUPPLIER.
 - ALL SIGNS AND ROAD MARKINGS ARE TO BE IN ACCORDANCE WITH TSRGD 2016.
 - THE LOCATION OF STATUTORY UNDERTAKERS APPARATUS SHOULD BE PROVIDED BY THE CONTRACTOR BEFORE UNDERTAKING ANY EXCAVATION.

01	14.09.18	ORIGINAL ISSUE	MBW	DWH	JJM
Rev	Date	Description	Drawn	Check	Approv

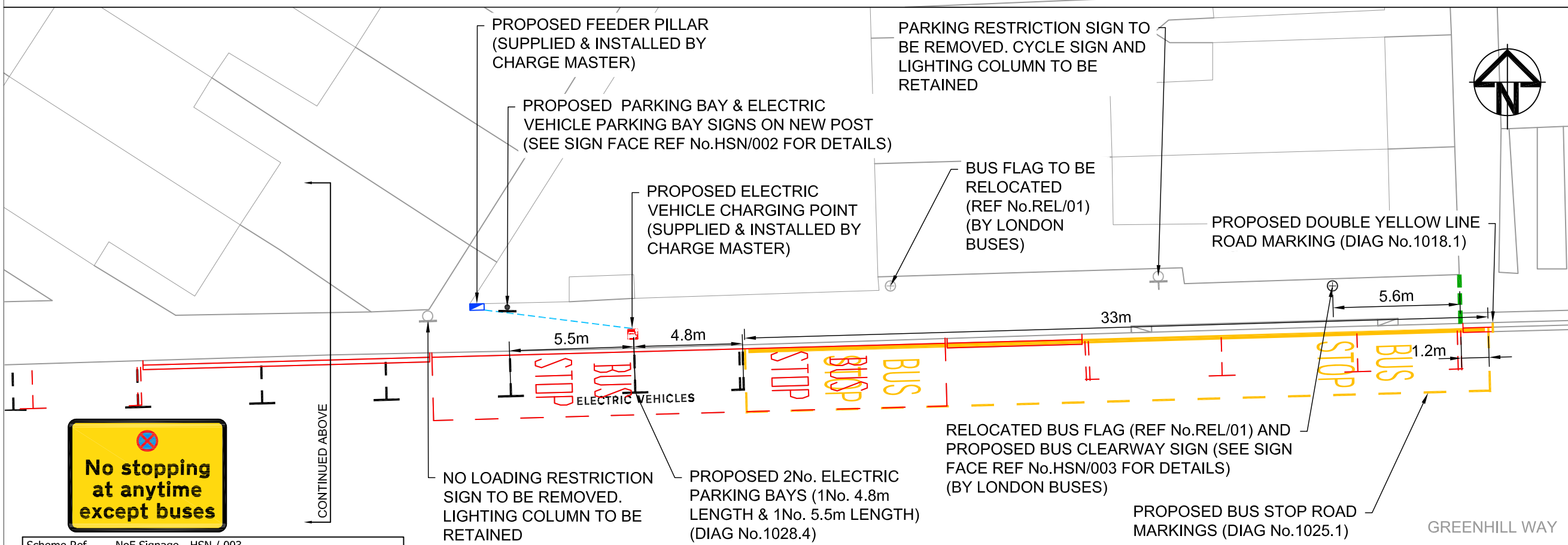

Scheme Ref.	NoF Signage - HSN / 003
Sign Ref.	Schedule 4, Part 1, Dia 1
Letter colour	BLACK
Background	YELLOW
Border	BLACK
Material	Class R2

THE MAPPING IS REPRODUCED FROM OR BASED UPON ORDNANCE SURVEY MATERIAL WITH THE PERMISSION OF ORDNANCE SURVEY ON BEHALF OF THE CONTROLLER OF HER MAJESTY'S STATIONERY OFFICE (C) CROWN COPYRIGHT. UNAUTHORISED REPRODUCTION INFRINGES CROWN COPYRIGHT AND MAY LEAD TO PROSECUTION OR CIVIL PROCEEDINGS. LONDON BOROUGH OF HARROW 100019206.

Client **Harrow COUNCIL** LONDON

PROJECT: NEIGHBOURHOOD OF THE FUTURE

Site: LONDON BOROUGH OF HARROW
 Client: HARROW COUNCIL
 STATION ROAD
 HARROW
 HA1 2XY
 www.harrow.gov.uk

ARCADIS Design & Consultancy
 Registered office: Arcadis House, 34 York Way, London, N1 9AB
 Coordinating office: Bernard Weatherill House, 8 Mint Walk, Croydon, CR0 1EA
 Tel: 44 (0)203 014 9000
 www.arcadis.com

TITLE: GREENHILL WAY ELECTRIC PARKING BAYS

Designed	M. WHEELER	Drawn	M. WHEELER	Date	SEPT 2018
Checked	D. HARDWICK	Drawn	J. MALYON	Date	14 SEPT 2018
Approved	J. MALYON	Date	14 SEPT 2018		
Scale:	As shown	Datum:	AOD		
Original Size:	A3	Grid:	OS		
Suitability Code:	Sx	Project Number:	10019769		

Suitability Description: **DETAIL DESIGN**
 Drawing Number: NoF/ARC/HGN/ZZ/DR/102
 Revision: 01

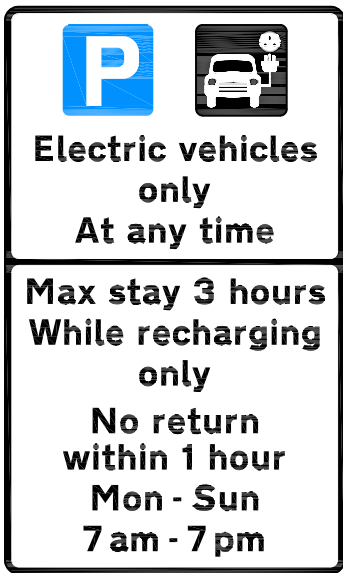

Scheme Ref.	NoF Parking Sign - HSN / 004		
Sign Ref.	Schedule 4, Part 1, Dia 2	x-height	20.0
Letter colour	BLACK	SIGN FACE	
Background	WHITE	Width	375mm
Border	BLACK	Height	625mm
Material	Class R2	Area	0.23m ²



- KEY:**
- PROPOSED SIGN & POST
 - PROPOSED ELECTRIC VEHICLE CHARGING POINT
 - PROPOSED 100mm UPVC DUCT FOR ELECTRICAL CABLE
 - PROPOSED FEEDER PILLAR
 - EXISTING ROAD MARKINGS TO BE REMOVED
 - PROPOSED YELLOW LINE RESTRICTIONS

- NOTES:**
1. ALL DIMENSIONS ARE IN METRES UNLESS STATED OTHERWISE.
 2. THIS DRAWING IS TO BE READ IN CONJUNCTION WITH THE FOLLOWING DRAWINGS No's:
NOF/ARC/HGN/ZZ/DR/101-103.
 3. DESIGN BASED ON OS PLANS.
 4. SIGNS & POSTS TO BE INSTALLED TO LBH SPECIFICATION. WITH A MINIMUM CLEARANCE OF 450mm FROM THE CARRIAGEWAY.
 5. FEEDER PILLAR, ELECTRIC CHARGING MACHINE AND ELECTRICAL SUPPLY TO BE SPECIFIED BY SUPPLIER.
 6. ALL SIGNS AND ROAD MARKINGS ARE TO BE IN ACCORDANCE WITH TSRGD 2016.
 7. THE LOCATION OF STATUTORY UNDERTAKERS APPARATUS SHOULD BE PROVED BY THE CONTRACTOR BEFORE UNDERTAKING ANY EXCAVATION.

01	14.09.18	ORIGINAL ISSUE	MBW	DWH	JJM
Rev	Date	Description	Drawn	Check	Approv

Client

PROJECT:
NEIGHBOURHOOD OF THE FUTURE

Site LONDON BOROUGH OF HARROW
Client HARROW COUNCIL
STATION ROAD
HARROW
HA1 2XY
www.harrow.gov.uk

ARCADIS Design & Consultancy for roads and built assets

Registered office: Arcadis House, 34 York Way, London, N1 9AB
Coordinating office: Bernard Weatherill House, 8 Mint Walk, Croydon, CR0 1EA
Tel: 44 (0)203 014 9000
www.arcadis.com

TITLE:
PLATINUM HOUSE
ELECTRIC VEHICLE PARKING BAYS

Designed	M. WHEELER	Skpd	14/09/18	Date	SEPT 2018
Drawn	M. WHEELER	Skpd	14/09/18	Date	SEPT 2018
Checked	D. HARDWICK	Skpd	14/09/18	Date	14 SEPT 2018
Approved	J. MALYON	Skpd	14/09/18	Date	14 SEPT 2018
Scale:	1:200	Datum:	AOD		
Original Size:	A3	Grid:	OS		
Suitability Code:	Sx	Project Number:	10019769		

Suitability Description: **DETAIL DESIGN**

Drawing Number:	NoF/ARC/HGN/ZZ/DR/103	Revision:	01
-----------------	-----------------------	-----------	----

THE MAPPING IS REPRODUCED FROM OR BASED UPON ORDNANCE SURVEY MATERIAL WITH THE PERMISSION OF ORDNANCE SURVEY ON BEHALF OF THE CONTROLLER OF HER MAJESTY'S STATIONERY OFFICE (C) CROWN COPYRIGHT. UNAUTHORISED REPRODUCTION INFRINGES CROWN COPYRIGHT AND MAY LEAD TO PROSECUTION OR CIVIL PROCEEDINGS. LONDON BOROUGH OF HARROW 100019206.

PROPOSED DOUBLE YELLOW LINE RESTRICTIONS (DIAG No.1018.1)

PROPOSED DOUBLE YELLOW LINE RESTRICTIONS (DIAG No.1018.1)

PROPOSED FEEDER PILLAR (SUPPLIED & INSTALLED BY CHARGE MASTER)

PROPOSED 2No. ELECTRIC PARKING BAYS (DIAG No.1028.4)

PROPOSED ELECTRIC VEHICLE PARKING SIGN ON NEW POST (SEE SIGN FACE REF No.HSN/004 FOR DETAILS)

PROPOSED ELECTRIC VEHICLE CHARGING POINT (SUPPLIED & INSTALLED BY CHARGE MASTER)

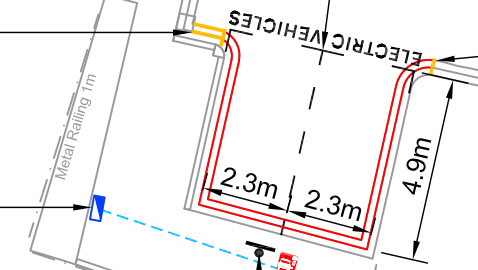

LYON ROAD (BEHIND PLATINUM HOUSE)

PLATINUM HOUSE

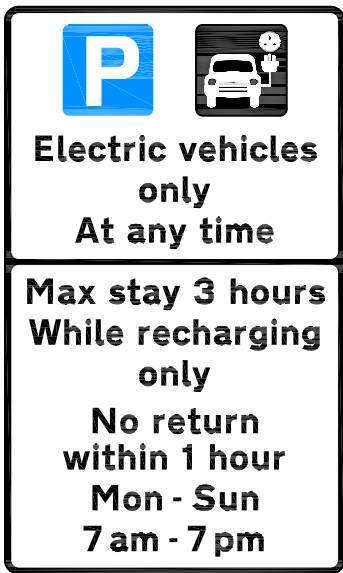

Scheme Ref.	NoF Parking Sign - HSN / 004		
Sign Ref.	Schedule 4, Part 1, Dia 2	x-height	20.0
Letter colour	BLACK	SIGN FACE	
Background	WHITE	Width	375mm
Border	BLACK	Height	625mm
Material	Class R2	Area	0.23m ²

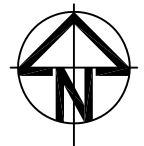
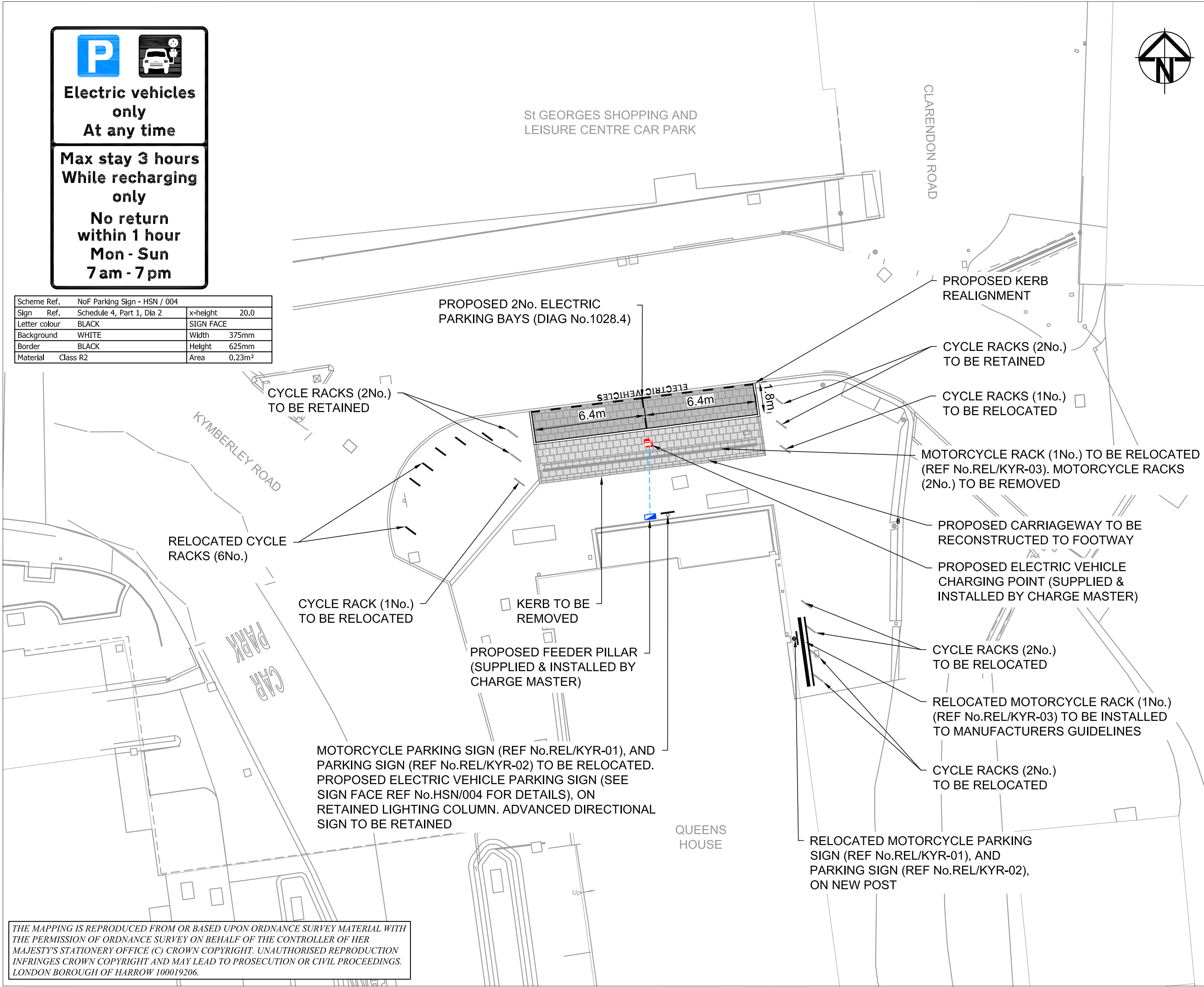

- KEY:**
- PROPOSED SIGN & POST
 - PROPOSED SIGN & RETAINED LIGHTING COLUMN
 - PROPOSED ELECTRIC VEHICLE CHARGING POINT
 - PROPOSED 100mm UPVC DUCT FOR ELECTRICAL CABLE
 - PROPOSED FEEDER PILLAR
 - EXISTING GRANITE PAVED CARRIAGEWAY TO BE RETAINED
 - PROPOSED MODULAR PAVED FOOTWAY (TO LBH SPEC)

- NOTES:**
1. ALL DIMENSIONS ARE IN METRES UNLESS STATED OTHERWISE.
 2. THIS DRAWING IS TO BE READ IN CONJUNCTION WITH THE FOLLOWING DRAWINGS No's: NOF/ARC/HGN/ZZ/DR/101-104.
 3. SIGNS & POSTS TO BE INSTALLED TO LBH SPECIFICATION, WITH A MINIMUM CLEARANCE OF 450mm FROM THE CARRIAGEWAY.
 4. FEEDER PILLAR, ELECTRIC CHARGING MACHINE AND ELECTRICAL SUPPLY TO BE SPECIFIED BY SUPPLIER.
 5. ALL SIGNS AND ROAD MARKINGS ARE TO BE IN ACCORDANCE WITH TSRGD 2016.
 6. THE LOCATION OF STATUTORY UNDERTAKERS APPARATUS SHOULD BE PROVED BY THE CONTRACTOR BEFORE UNDERTAKING ANY EXCAVATION.

01	16.09.18	ORIGINAL ISSUE	MBW	DWH	JJM
Rev	Date	Description	Drawn	Check	Approv

Client

PROJECT:
NEIGHBOURHOOD OF THE FUTURE

Site LONDON BOROUGH OF HARROW
Client HARROW COUNCIL
STATION ROAD
HARROW
HA1 2XY
www.harrow.gov.uk

ARCADIS Design & Consultancy for roads and built assets

Registered office: Arcadis House, 34 York Way, London, N1 9AB
Coordinating office: Bernard Weatherill House, 8 Mint Walk, Croydon, CR0 1EA
Tel: 44 (0)203 014 9000
www.arcadis.com

TITLE:
KIMBERLEY ROAD
ELECTRIC VEHICLE PARKING BAYS

Designed	M. WHEELER	16/09/18	16 SEPT 2018
Drawn	M. WHEELER	16/09/18	16 SEPT 2018
Checked	D. HARDWICK	16/09/18	16 SEPT 2018
Approved	J. MALYON	16/09/18	16 SEPT 2018
Scale:	1:200	Datum:	AOD
Original Size:	A3	Grid:	OS
Suitability Code:	Sx	Project Number:	10019769

Suitability Description:
DETAIL DESIGN

Drawing Number:	NoF/ARC/HGN/ZZ/DR/104	Revision:	01
-----------------	-----------------------	-----------	----

THE MAPPING IS REPRODUCED FROM OR BASED UPON ORDNANCE SURVEY MATERIAL WITH THE PERMISSION OF ORDNANCE SURVEY ON BEHALF OF THE CONTROLLER OF HER MAJESTY'S STATIONERY OFFICE (C) CROWN COPYRIGHT. UNAUTHORISED REPRODUCTION INFRINGES CROWN COPYRIGHT AND MAY LEAD TO PROSECUTION OR CIVIL PROCEEDINGS. LONDON BOROUGH OF HARROW 100019206.